



PVC SHOWER WALL PANELS



Designed for walls, PVC shower wall panels are a stylish and cost effective alternative to tiles. The PVC panels are 100% waterproof, making them perfect for showers, bathrooms and wetrooms.

RECOMMENDED TOOLS



SILICONE SEALANT & ADHESIVE



PENCIL



TAPE MEASURE



STRAIGHT EDGE



FINE TOOTHED SAW / UTILITY KNIFE



MASKING TAPE



SAFETY GLOVES & EYE WEAR



PVC CLEANER

HANDLING & STORAGE

PVC shower wallpanels are resistant to UV light however you should avoid storing PVC shower wall panels for long periods of time in areas with prolonged or intense sunlight.

All panels should be stored flat or vertical, avoid leaning the panels against walls or objects as the flexible nature of the panels may induce permanent bowing.

PVC shower wall panels weight approximately 11kg including packaging.

Due to the size and flexibility of PVC shower wall panels, a minimum of 2 people should handle the panels when lifting and moving.



FITTING GUIDANCE

PREPARATION

PVC shower wall panels must be stored flat in the room in which they are to be fitted for at least 48 hours before being installed, this allows the panels to acclimatise to the temperature and moisture in the environment.



Before fitting the PVC shower wall panels, check each panel to ensure they are the same batch and are of a suitable colour match. The batch number can be found on the packaging and on the reverse of the panel.

PVC shower wall panels are installed using PVC adhesive so it is important that all substrate surfaces which the panel is being adhered to are sound, clean, dust free, dry and even.



PVC shower wall panels can be fitted directly onto tiles as long as the tiles are secure and flat. The tile must be well cleaned and ideally sanded/roughed first to allow the adhesive to form a strong bond with the tiles.

Any paints, sealers or coatings on the substrate surface should be checked for adhesion stability and if in doubt, should be removed before you install the shower panels.

If the wall substrate is uneven, then an appropriate timber batten frame system must be installed with 50cm centred vertical and horizontal battens. PVC shower wall panels are not weight bearing, where any items such as shower units, shower rails or sink basins are to be fixed through the panels, install support battens into the framing system to support and fix these items to.



CUTTING

Gloves and eye protection should be worn when cutting PVC shower wall panels.

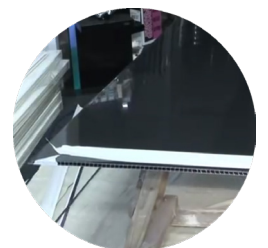

With the decorative side facing up, apply masking tape along the area which is to be cut, this will help ensure a clean cut is achieved and avoid any splintering or cracking of the PVC panel during cutting.

Using a pencil, mark the lines/area which is to be cut and use a fine-toothed saw or utility knife to cut the PVC shower wall panel. If using a utility knife you will need to make a number of passes with the knife in order to cut through the PVC panel.



Trims can be cut using a fine-toothed saw, the use of a mitre box is recommended to achieve accurate cuts and angles.

FITTING GUIDANCE

PLANNING

Before fitting begins, set out where your panels will be located so you can establish what trims and accessories are required for each panel.

Where two 1000mm wide panels are to be fitted in a continual run, a H-joint trim profile must be used to join the two panels together to ensure a waterproof seal is maintained.

ACCESSORIES

All accessories are available in Silver, Black or White.

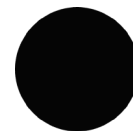
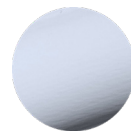

INTERNAL CORNER



Used on internal 90° corners

EXTERNAL CORNER



Used on external 90° corners

END CAP

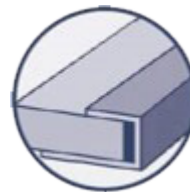

Finishing end cap for square cut edge panel

H-JOINT



Used to mount panels side by side

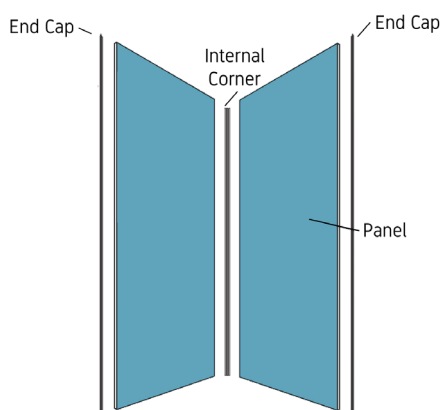

A typical corner shower area you would require:

- x2 PVC shower wall panels
- x2 End caps
- x1 Internal corner

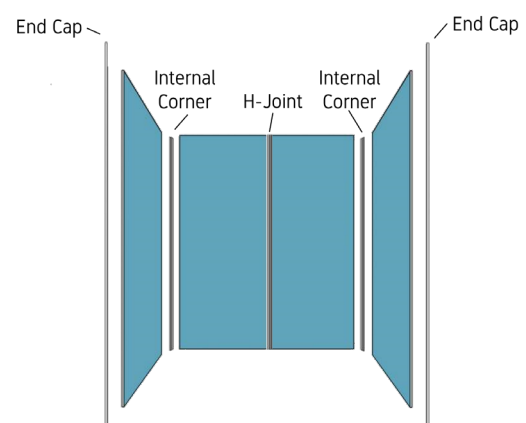

A typical bath surround would require:

- x4 PVC shower wall panels
- x2 End caps
- x2 Internal corner
- x1 H-joint

FITTING GUIDANCE

SETTING A STARTING POINT

Establish a starting point for the first PVC shower wall panel, this is often an internal corner which you can then build out from.

Using the shower wall adhesive, apply a thick bead of adhesive along the back of an internal corner profile and adhere it into the corner of the wall or batten frame.

Alternatively, you can mechanically fix the profile to the substrate using suitable countersunk screws.

If starting from a flat wall, attach an end cap to the wall or batten frame using either the shower panel adhesive or by mechanically fixing the profile with countersunk screws.

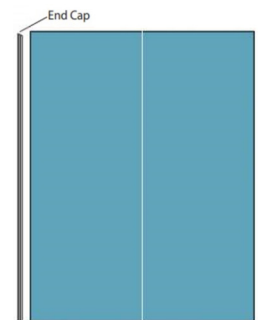
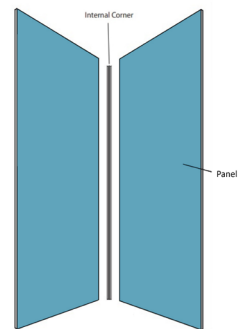

FITTING A TRIM TO THE FIRST PANEL

Before fitting a panel into the profile you have attached to the wall, you must attach an appropriate end cap or H-joint profile to the opposite edge of the shower panel.

I.E. The edge which is opposite to the edge going into the profile attached to the wall.

Remember, if you are attaching two 1000mm shower panels in a continual run then a H-joint must be used.

Apply a full unbroken length of silicone sealant into the channel of the trim profile (1)

Push the profile onto the panel edge and into the silicone sealant (2), wipe away any excess silicone from the panel joint and panel surface immediately.

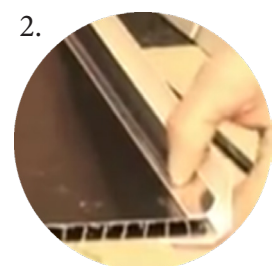
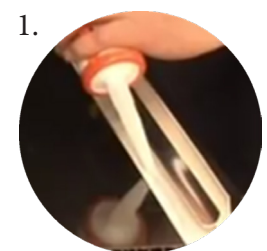

FITTING GUIDANCE

ATTACHING THE FIRST PANEL TO THE WALL

Apply a full unbroken length of silicone sealant into the channel of the trim profile which you attached to the wall as your starting point(1).

Apply a thick bead of shower wall adhesive around the back periphery edge of the panel (50mm in from the panel edge), followed by horizontal beads of adhesive every 45cm across the back of the panel.

Include a thick bead of adhesive down the back of the trim profile attached to the board as well (2).

Where a timber batten frame system has been fixed to the wall, apply the adhesive to the battens rather than the back of the PVC shower panel and trim profile.

Fit the edge of the shower panel without the trim attached into the trim profile that is attached to the wall and push it firmly into the silicone sealant.

Once firmly slotted into the profile push the panel firmly against the wall ensuring the panel and its attached trim profile make full contact with the substrate at all points (3).

Remove any excess silicone from the joint or panel surface immediately.

If you are mechanically fixing the H-joint profiles to the wall with countersunk screws, you will need to push the panel onto the wall first before fixing the trim profile into place.

1.

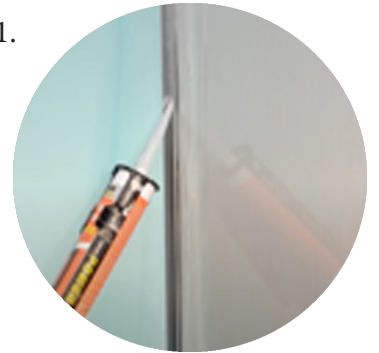

2.

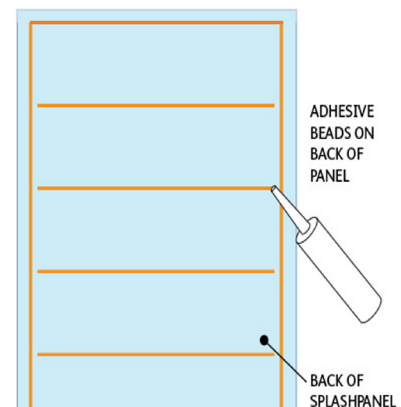

Use 1 tube of adhesive per board

3.

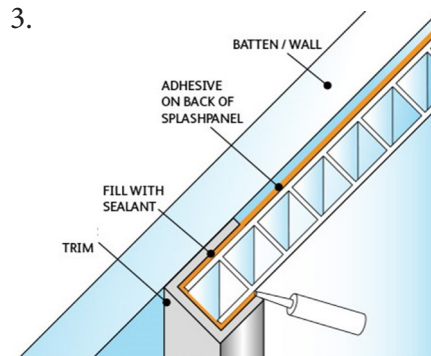

FITTING GUIDANCE

CONTINUING THE INSTALLATION

Continue fitting the shower panels by attaching the appropriate trim profile to the edge of the panel using silicone sealant and filling the trim profile attached to the wall with silicone sealant.

Apply panel adhesive to the back of the panel and profile trim as in the previous step and then push the panel into the exposed trim profile on the wall and onto the substrate.

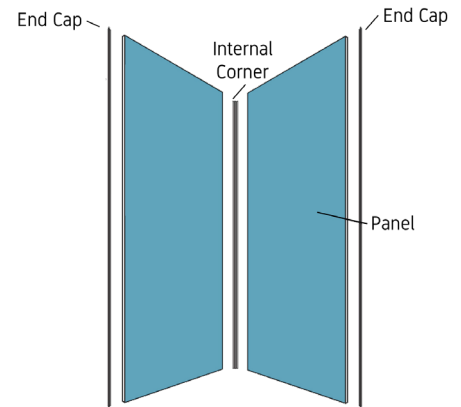

FINISHING THE INSTALLATION

Finish the installation by measuring and cutting the last panel to size and seal the final edge using silicone sealant and an end cap.

Apply adhesive to the back of the panel and end cap trim as before, then as one unit push the shower panel into the channel of the trim profile which is on the wall and press the unit securely to the substrate.

Ensure all panel joints, bottom edges, sides and edges around sinks, baths, shower units and any pipes or cut outs are fully sealed using silicone sealant.

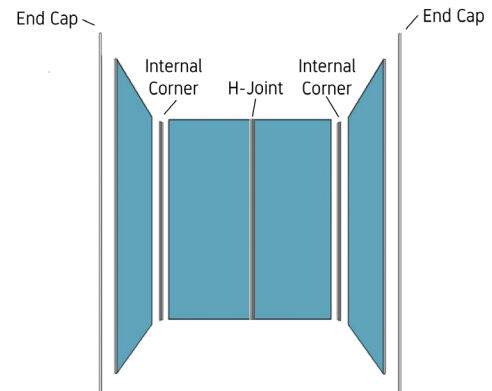

FITTING GUIDANCE

ATTACHING FIXTURES

PVC shower wall panels are not weight bearing and so any fixtures being attached must go through the panel be mechanically attached to the substrate or to a timber batten within the framework.

Use a drill bit suitable for the substrate you are drilling into, i.e. a masonry drill bit for brick, as this will prolong the life of your drill bit and make the drilling easier.

Using a small drill bit, drill through the PVC shower wall panel and create a pilot hole. Then use the required size drill bit to drill fully through the PVC panel and into the substrate (1).

You can crush the honeycomb structure of the PVC shower wall panel by overtightening a fixture to the wall (2) and so a spacer should be used protect the PVC panel.

A spacer can be created by using a longer wall plug which sits within the hole of the substrate and is flush with the surface of the PVC panel (3). This will stop the screws from putting too much pressure on the panel when tightened.

Alternatively a small piece of copper piping or a stack of small washers can be used to create a spacer which is the thickness of the PVC panel (4).

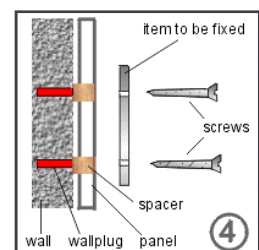
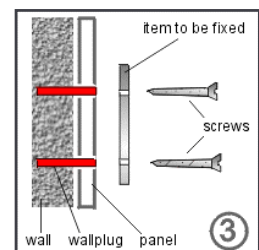
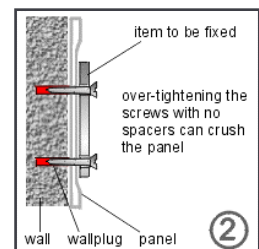
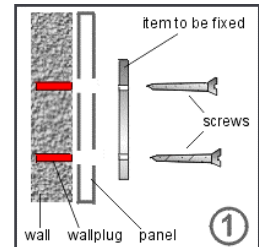

Any hole made through a PVC shower wall panel must be sealed with silicone sealant to maintain a waterproof seal.

CARE & MAINTENANCE

Once installed, your PVC panels only require occasional ongoing maintenance using a suitable PVC Antibacterial Cleaner such as BAL Micro-Shield Plus.



PLEASE NOTE: Abrasive cleaners and bleaches MUST NOT be used on PVC shower wall panels as this can damage the decorative layers of the panel.